



Second Floor, 32 Southmoor Road, Jericho, Oxford, OX2 6RD

Location: Walton Manor, Oxford

Type: One-bedroom flat SUITABLE FOR 1 PERSON ONLY

Floor: Second Floor

Interior Features:

Living Area: Large sunny sitting room

Bedroom: Spacious bedroom overlooking the rear garden

Bathroom: Private shower room

Kitchen: Shared kitchen with one other flat, equipped with a washing machine and microwave

Exterior Features:

Outdoor Space: Use of rear communal garden

Additional Information:

Council Tax: Band C (split between first and second floor flats, approximately £105.00 pcm each)

Summary

****PROPERTY WILL BE DECORATED BEFORE TENANCY STARTS**** Situated in a superb location on a much sought-after road in Walton Manor, this charming second-floor one-bedroom flat offers comfortable living just a

- 1 Bedroom
- 1 Reception and SHARED Kitchen
- 1 shower room
- Jericho
- Furnished Property
- Flat
- Communal
- Band C- split between 2 flats
- Permit Parking Available

£1,215 PCM

Second Floor

Approx. 29.1 sq. metres (313.5 sq. feet)

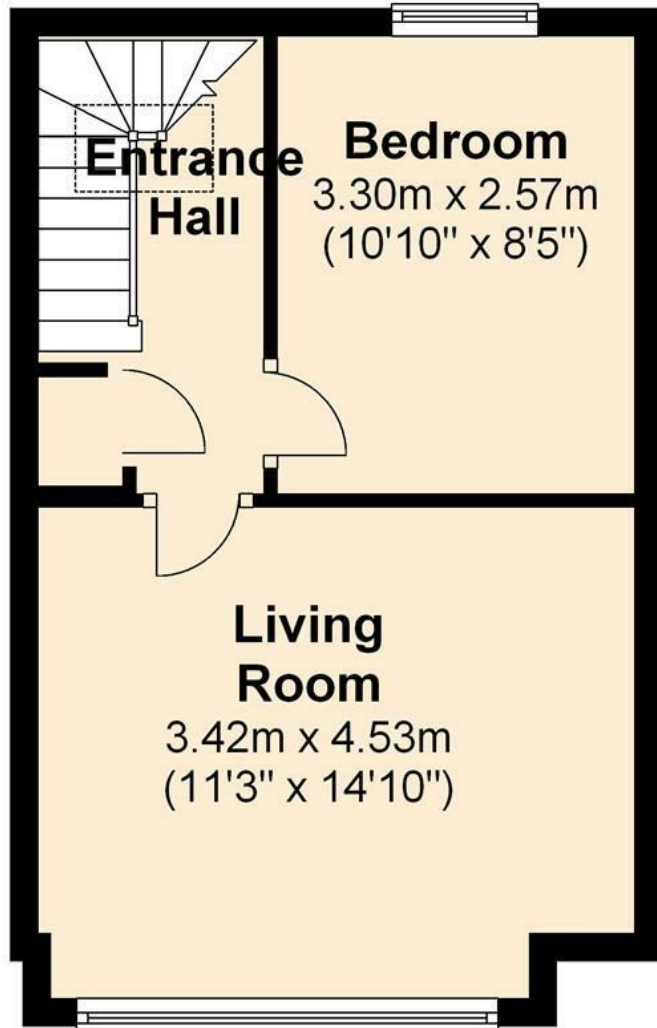
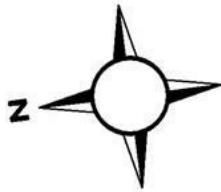

Total area: approx. 29.1 sq. metres (313.5 sq. feet)

Energy Efficiency Rating		Current	Potential
Very energy efficient - lower running costs			
(92 plus) A			
(81-91) B			
(69-80) C			
(55-68) D			
(39-54) E		55	68
(21-38) F			
(1-20) G			
Not energy efficient - higher running costs			
England & Wales		EU Directive 2002/91/EC	

Environmental Impact (CO ₂) Rating		Current	Potential
Very environmentally friendly - lower CO ₂ emissions			
(92 plus) A			
(81-91) B			
(69-80) C			
(55-68) D			
(39-54) E		55	68
(21-38) F			
(1-20) G			
Not environmentally friendly - higher CO ₂ emissions			
England & Wales		EU Directive 2002/91/EC	